



**THE 17TH INTERNATIONAL SYMPOSIUM ON SOCIETY & RESOURCE MANAGEMENT
(ISSRM 2011) SABAH, MALAYSIA 13th – 17th JUNE 2011, LE MERIDIEN HOTEL,
KOTA KINABALU, SABAH, MALAYSIA**



SUMMARY OF EVENTS

Date /Venue	Event /Activity	Time
13 th June 2011 UMS Campus	Post-graduate day (Pre-Conference Activity)	8.00am - 4.30 pm
13 th June 2011 Le Meridien Hotel	Pre Registration	3.00pm - 6.00pm
14 th June 2011 Le Meridien Hotel	Registration Opening Ceremony (The Minister of Tourism, Culture and Environment, YB Datuk Masidi Manjun) Keynote (Ballroom) Members Meeting (All conference delegates are invited to attend) General Sessions Welcome Dinner and cultural show – Free to all conference delegates but must register	7.30am – 9.00am 9.00am – 10.00am 10.00am -10.45am 10.45am -12.00pm 2.00pm - 5.45pm 7.00 - 10.00pm
15 th June 2011 Le Meridien Hotel	General Sessions Keynote (Sipadan Room) General Sessions Poster Exhibition	8.30am - 10.45am 11.00am - 12.15pm 2.00pm - 3.45pm 4.00pm - 5.45pm
16 th June 2011 Le Meridien Hotel	General Sessions Keynote (Sipadan Room) General sessions	8.30am - 10.45am 11.00am - 12.15pm 2.00pm - 5.45pm
17 th June 2011 Le Meridien Hotel	General Sessions Closing Ceremony and (cultural show)	8.30am - 10.45am 11.00am - 1 pm
18-22 June 2011	Post Conference Tour http://www.issrm2011malaysia.iasnr.org/index.php?L1=left_home.php&L2=body_Post_Conference_Tour.php	Private arrangement with tour operators

TENTATIVE SCHDEULE OF PRESENTATION

[Categories, Sub-themes and Organised Sessions]

SECTION A GENERAL SESSION	SESSION NO	GENERAL SESSIONS/THEMES
	1	Agriculture, Forestry and Fisheries
	2	Climate Change, Carbon Reduction and Natural Disaster
	3	Community and Social Impact Assessment
	4	Conservation, Policies and Wildlife
	5	Education, GIS and Public Participation
	6	Energy and Mining
	7	Environment and Natural Resources Management
	8	Indigenous Peoples and Sustainable Development
	9	Landscape and Land Use Planning
10	Parks, Recreation and Tourism	
SECTION B ORGANISED SESSION	SESSION NO	ORGANISED SESSIONS/THEMES
	11	Cultures of Oil Palm
	12	Nurturing new geographies of coexistence
	13	The role of politics, economics and science communication in climate change adaptation behaviour
	14	Water, Lifestyle and Urban Sustainability in Malaysia
	15	Transacting Property Rights in Forest Carbon
	16	A Unifying Framework for Understanding and Evaluating Natural Resource Negotiation and Decision Situations
	17	The impacts of the imperfect storm on Northeast Japan
18	Roundtable and Panel on Indigenous and Community Conserved Areas: Challenges, Opportunities, and Next Steps	
SECTION C POSTER SESSION	POSTER	POSTER SESSION

MASTER SCHEDULE (TENTATIVE – SUBJECT TO CHANGE)

TIME & VENUE	13.06.2011	14.06.2011, Conference Room					15.06.2011, Conference Room					16.06.2011, Conference Room					17.06.2011, Conference Room								
	UMS Campus	R1	R2	R3	R7	R5		R1	R2	R3	R6	R5	R4		R2	R3	R4	R5	R1	R1	R2	R3	R4		
8.30 -10.45 am	PG	REGISTRATION OPENING CEREMONY						1.3	2.3	5.1	7.3	8.1		10.1 (R8)	12.2	10.4	10.2	16.1	13.1	11.1	15.2	9.2			
11.00 - 12.45 pm	PG	Keynote by Prof. Tanya Murray Li Members Meeting						K2 (R4) Keynote by Prof. Richard Howitt						K3 (R4) Keynote by Mdm. Jannie Lasimbang					Closing Ceremony (R7)						
12.45 – 2.00		LUNCH BREAK															Luncheon								
2.00 - 3.45 pm	PG	1.1	2.1	1.4	7.1	6.1		17.1	14.1	3.1	7.4	8.2		18.1 (R7)	11.2	12.1	10.5	10.3	15.1						
4.00 - 5.45 pm	REGISTRATION 3.00 – 7.00PM	1.2	2.2	1.5	7.2			Poster Presentation (3 rd Floor Foyer)						18.2 (R7)	4.1	9.1	10.6	11.3	16.2						
6.30 -9.30 pm		Welcoming Dinner																							
DAILY SESSION							PRESENTATION							KEYNOTE											
Session 1 (Morning), tea break at 10.45-11.00 am Session 2 (Noon), lunch break at 12.45 -2.00 pm Session 3 (Afternoon), tea break at 3.45 pm Session 4 (Late Afternoon), concluded at 5.45 pm							K = Keynote Address O = Opening Ceremony P = Poster Presentation General Thematic Sessions: 1 - 10 Special Organised Sessions: 11 - 18 PG = Postgraduate Event							K1 = Keynote by Prof. Tanya Murray Li K2 = Keynote by Prof. Richie Howitt K3 = Keynote by Mdm. Jannie Lasimbang											
CONFERENCE ROOM							Notes All rescheduling of events and sessions must refer ONLY to Dr. Ramzah Dambul and his team. He or his agents will be around throughout the conference period, most likely at TENOM ROOM. HINT: Your name is listed on last page (sorted by LAST NAME), on the left column is YOUR SESSION NUMBER																		
Main Room = Kudat & Kudasang R1 = Manukan Room R2 = Gaya Room R3 = Mamutik Room R4 = Sipadan Room R5 = Tenom Room R6 = Mabul Room (Second Floor) R7 = Keningau Room R8 = Training Room 8 th Floor Secretariat = Selingan Room																									

3rd Floor Plan – Main Conference Area

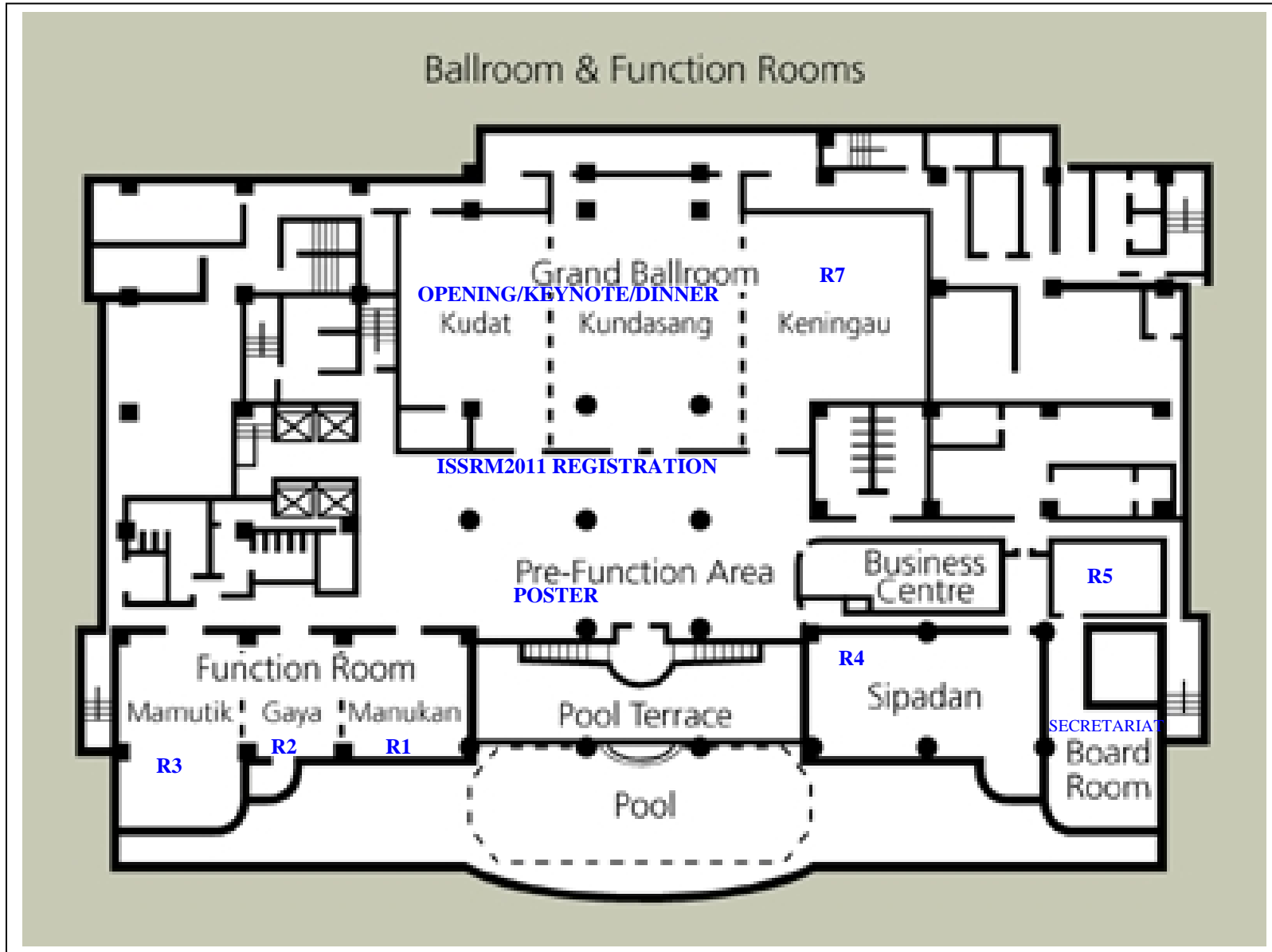

SECTION A: GENERAL SESSION

SESSION NO	CATEGORY THEMES	PAPER				
		Session Sub-No	Paper No	ID No	Author	Title
1	Agriculture, Forestry and Fisheries	1.1	Chair :			
			A	1597	ARIFFIN, Jamilah	THE EFFECTIVENESS OF IMPLEMENTING CONTRACT FARMING SYSTEM IN INCOME GENERATING: THE CASE OF MUSHROOM FARMING IN MOYOG, SABAH
			B	1477	RAHMAN, Syed A **	Increasing Tree Cover in Degrading Landscapes: 'Integration' and 'Intensification' of Smallholder Forest Culture in the Alutilla Valley, Matiranga, Bangladesh
			C	1654	KhimPhin Chong (UMS)	Enhancing crop defense mechanism: a sustainable agriculture approach for the betterment of environment and society
			D	1474	Andreas Thulstrup	Production or protection? Plantation expansion and repercussions for protected forest areas in a central Vietnamese commune
		1.2	Chair :			
			A	1579	JAKIMOW, Tanya R	Livelihood portfolios in agrarian Andhra Pradesh: the contribution of a qualitative approach to sustainable livelihood analysis
			B	1332	JONES, Robert E	Identifying the Barriers and Bridges to High Tunnel/BDM Production Systems among Specialty Crop Producers in the USA
			C	1432	Kuenga Namgay	Transhumant agro pastoralism in Bhutan: An uncertain future
			D	1380	GOLDSTEIN, Jenny E	Producing quality and value in Sulawesi: Landscapes and livelihoods in the Pacific coffee trade (**Request – NP)
		1.3	Chair :			
			A	1494	MILLAR, Joanne E	Seeing is believing: social transformation through livestock development in Lao Peoples Democratic Republic
			B	1475	Tim Scrase	Sustainability and fair trade tea production in Sri Lanka
			C	1390	Anastasiya Shtaltovna	The Role of Agricultural Service Organizations in the Process of Agricultural Transformation in the Khorezm Province, Uzbekistan
			D	1447	Trent Brown	Social Movements, NGOs and Sustainable Agriculture: The Case of the Kheti Virasat Mission, Punjab, India
		1.4	Chair : Dr. Sunny Sanderson, The University of Queensland			
			A	1470	Jack Sirey	Assessing the Feasibility of Dedicated Urban Forestry Carbon Markets in the United States
			B	1530	TSUCHIYA, Toshiyuki	Local Governance in National Forest Management in Collaboration with Environmental NGO and Local Community: Challenge of Akaya Project in Japan
			C	1532	WANG, Hurng-Jyuhn	The factors to affect public participation of community forestry program: The cases of LIN-MEI, CHIU-SHI and HUBAN communities
			D	1469	Bob Izlar (Jack Sirey 1470)	Commodification of Forest Resources and Environmental Goods and Services in the southern United States: Outcomes and Lessons
		1.5	Chair : Dr. Yuan-Cherng Hwang, Science and Technology Institute of Northern Taiwan			
			A	1481	WILLIAMS, Liana J	Collective versus individual resource management: A case study of livestock farming in Eastern Indonesia
			B	1620	HWANG, Yuan-Cherng	The Coast –Benefit Study to Promote the Mainstream of Tourism Oriented New Emerged Plantation--Jatropha Farming
			C	1401	MOSTEGL, Nina M	Where is the catch? A closer look at the fishing surveys of British Columbia to reveal angler preference and motivation
			D	1669	Nancy Arizpe	The transition of agricultural production systems. A multiscale approach in rural communities in developing countries (Latin America and Asia)

SESSION NO	CATEGORY	PAPER				
		Session Sub-No	Paper No	ID No	Title	
2	Climate Change, Carbon Reduction and Natural Disaster	2.1	Chair : Prof. Chin Siong Ho, UTM			
			A	1419	Noel Chellan	Climate Change: Revisiting the Science and Politics
			B	1526	Johan Nordensvard	The role of governments and corporations in climate change mitigation: a critical appraisal of corporate citizenship
			C	1333	Md. Ubydul Haque	Reduced deaths rate from cyclone in Bangladesh - what more needs to be done
			D	1422	Mia Landauer	Nordic policies and practises in competitive environmental management of winter tourism
		2.2	Chair : Mr. Boyd Joeman, ISKANDAR Malaysia			
			A	1616	CHIN SIONG HO (Boyd Joeman)	DEVELOPMENT OF SUSTAINABLE REGION USING LOW CARBON SOCIETY CONCEPT- THE CASE OF ISKANDAR MALAYSIA
			B	1467	HOU, Jing-Shoung	Applied Theory of planned behaviour to study low-carbon travel behaviour intention
			C	1381	Evonne Miller	Our Actions, our Mess, our responsibility': older Australians views on climate change and sustainability
		2.3	Chair :			
			A	1561	Mahadirin Hj Ahmad	Response and Action of Trade Union To Climate Change: An Overview
			B	1589	Judelyn Salon	Climate Variability and Local Adaptation in Selected Barangays in Iligan City, Philippines
			C	1455	Norhazimah A HALIM	Evaluation of Oil Palm Trunks (Elaeis guineensis) Sap for bio-fuel production
		D				

SESSION NO	CATEGORY	PAPER				
		Session Sub-No	Paper No	ID No	Title	
3	Community and Social Impact Assessment	3.1	Chair : Dr. Sunny Sanderson, The University of Queensland			
			A	1541	Catur Arik Kurniawati	Assessment of water quality in Surabaya River, East Java province, Indonesia
			B	1510	Dau-Jye Lu	From counter-reservoir, community forestry, to protected area-what does ecology of countryside can count on
			C	1485	Siang Choon Foo	Title: Community Based Conservation: Local Women Group Champions Mangroves Replanting in Setiu, Terengganu
			D	1402	Bing-Yan	Innovation and challenges of Taroko's public leadership

SESSION NO	CATEGORY	PAPER				
		Session Sub-No	Paper No	ID No	Title	
4	Conservation, Policies and Wildlife	4.1	Chair :			
			A	1412	Toshio Meguro	The nexus of unpredicted negative outcomes of community-based conservation under the discrepancy in the understanding of wildlife conservation from the case of southern Kenya
			B	1461	Megha Budruk	Extending the three dimensional place attachment model: Spirituality and nature as new dimensions of place attachment
			C	1498	Ayumi Sugimoto	Local Dynamics beyond Recentralization of Decentralized Forest Policy: A case study on Community-based Forest Management in the Philippines
		D				

SESSION NO	CATEGORY	PAPER					
		Session Sub-No	Paper No	ID No	Author	Title	
5	Education, GIS and Public Participation	5.1	Chair :				
			A	1576	Delene Weber	Towards a transdisciplinary approach to natural resource management: can GIS play a role?	
			B	1509	Umi A' Zuhrah Abdul Rahman	CONSERVATION AND ISLAM: INFUSING CONSERVATION MESSAGES IN ISLAMIC SERMONS IN MALAYSIA	
			C	1371	Patmawaty Taibe **	VIDEO COMMUNITY AND GEOGRAPHIC INFORMATION SYSTEM (GIS) AS APPROACH TO BOOTS ENVIRONMETAL AWARENESS FOR FLOOD IN SINTANG WEST BORNEO INDONESIA (Intervention Study in community strain Kapuas and Melawi rivers)	
			D	1484	AKAMINE, JUN	Die in peace and come back again: Functions of memorial services for wildlife in marine resource management in Japan	

SESSION NO	CATEGORY	PAPER					
		Session Sub-No	Paper No	ID No	Author	Title	
6	Energy and Mining	6.1	Chair :				
			A	1456	Ruchira Ganguly-Scrase	Damming development: Lepcha dispossession in the Himalayas	
			B	1493	Wan-Ting Liao	Effects of the Ambiances of Urban Lighting on Preferences	
			C	939	Paulus Mau	BC Hydro's long-term consumer demand response rate design model: on-peak electricity usage reduction using rate structures	
			D	1536	Frauke Urban	Natural resource management in the hydropower sector: China's involvement in Southeast Asia	

SESSION NO	CATEGORY	PAPER				
		Session Sub-No	Paper No	ID No	Author	Title
7	Environment and Natural Resources Management	7.1	Chair :			
			A	1516	Wei-Lin Chen	A Participatory Management Model Integrating with the Protected Area Management: An Application of Formosan Landlocked Salmon Conservation in Taiwan
			B	1336	Claudia Baldwin	Negotiating Water: Issues of Justice, Power and Knowledge
			C	1448	Jung-Yi Lai	Mangroves Restoration in Kaohsiung Jhong-Dou Wetland Park
			D	1490	An-chi Peng	The Influential Factors of Community-based Monitoring: A case study of Wu-Wei-Kang Waterfowl Refuge, Ilan, Taiwan
		7.2	Chair : Dr. Aurela Gomez, Chars Darwin University, AU			
			A	1643	Khaleda Begum	Impact of pollution in Shitalakkhya River on human health
			B	1521	BALVINDER KLER	Sense of Place: A Framework for Understanding SCUBA Divers and Pro-Environmental Behaviour towards the Red Sea, Egypt
			C	1379	Terrie Wong	Scent of a woman / Sense of a place: Reimagining sense of place through performance
			D	1378	Shoana Humphries	Community-based forest enterprise models in the Brazilian Amazon and Southeastern Mexico
		7.3	Chair:			
			A	1410	Aditi Mankad	Urban decentralised water: Community acceptance, perceptions of knowledge and barriers to adoption
			B	1666	Anna Lukasiewicz	Where is the justice in Australian water reform
			C	1413	BARTEL, Robyn L **	Environmental laws and agriculture: conflicting motivations?
			D	1463	KARMANN, Marion (S. Humphries 1378)	Commodification of forest resources: Forest management certification as tool to stimulate incentives for communities to value forest resources
		7.4	Chair: Boyd Joeman, ISKANDAR Malaysia			
			A	1399	Masatoshi Sasaoka	Adaptability of Resource Management based on Supernatural Enforcement Mechanisms to Local Socio-cultural Context: Toward self-directed resource management by the people who 'coexist with supernatural agents'
			B	1492	Sofia Johari **	Collaborating for Change in the Proposed Tun Mustapha Park: Community development and alternative livelihoods approaches
			C	1350	Ying-Hung Li	The congruence and differences between stakeholder groups in the identification of potential indicator list at Nanan of Yushan National Park, Taiwan
			D	1595	Jurry Foo	Local community response on access limitation to natural resources in Tagal system

SESSION NO	CATEGORY	PAPER					
		Session Sub-No	Paper No	ID No	Author	Title	
8	Indigenous Peoples and Sustainable development	8.1	Chair : Dr. Sunny Sanderson, The University of Queensland				
			A	1486	Indranil Bose	The Impact of Green Supply Chain Management Initiatives on Firm Value	
			B	1426	Awae Masae	Structural Change and Local People's Adjustment to Sustain Resource-based Livelihoods in Khuan Khreng Peatlands, Southern Thailand	
			C	1331	Gregory McCann	Spirit Places: Bioregionalism's Missing Link	
			D	1330	Muhammad Kamran	No one size fits all! How colonial policies failed to consider social, economic and ecological wisdom embedded in customary rights in Tribal areas irrigation systems of Pakistan?	
		8.2	Chair :				
			A	1347	Taisuke Miyauchi	Managing livelihood combination and common-pool system: a case study of local sustainable development in fishing villages in the Jusanhama area of Miyagi, Japan	
			B	1374	Robert Peters	INDIGENOUS KNOWLEDGE AS A GIFT; Beyond a Resource for Commoditization	
			C	1487	Hsin-Han Wang	The Practices of Local Knowledge in the Progress of Taiwanese Indigenous Environmental Event : A Case Study of Tgbil-Incident in Tayal Smangus Tribe	
			D	1501	Luchi Sevidal Castro **	The seasonal calendar of the Subanun in Mt. Malindang in Mindanao, the Philippines: indigenous knowledge systems and adaptive strategies	

SESSION NO	CATEGORY	PAPER					
		Session Sub-No	Paper No	ID No	Author	Title	
9	Landscape and Land Use Planning	9.1	Chair : Gregory McCann, Tamkang University				
			A	1503	Jing-Shoung Hou	Naturalness and Emotional Experience of Place - A Case Study of Taichung SiTun Residential District	
			B	1473	Pei-Hsin Hsu	The Multi-Territory: Emotional landscape of Yuanyang Lake Nature Reserve in Taiwan	
			C	1496	Ying-Chun Chen	Effects of Street Facade Complexity on Landscape Preferences	
			D	1351	GOMEZ, AURELIA LUZVIMINDA V	The value of watershed protection in Mt. Apo Natural Park, Philippines	
		9.2	Chair :				
			A	1493	Wan-Ting Liao	Effects of the Ambiances of Urban Lighting on Preferences	
			B	1464	Shih-Yung Liu	The Creative Life Industry Promotes and Operates Studying in Taiwan	
			C	1465	Yi-Ching Liu	Aesthetic Engineering Study for Taiwan's Art District	
			D	1506	Yi-Ching Liu	Vocational Schools in the field of interior design creativity of students	

SESSION NO	CATEGORY	PAPER				
		Session sub-No	Paper No	ID No	Author	Title
10	Park, Recreation and Tourism	10.1	Chair : Dr. Neelam C. Poudyal, University of Georgia, USA			
			A	1566	GHA SEMI, Moslem	Assessing the tensions between local community empowerment versus environmental conservation in Community-Based Ecotourism (CBET), case study of Ulu Geroh, Perak
			B	1542	GOKITA, Reiko	Psychological benefits of national park visitors in Japan
			C	1383	HSU, Yi-Chung	Identification of outstanding remarkable values of Taroko National Park, Taiwan
			D	1325	Rosazman Hussein	FROM CONSERVATION EFFORT TO COMMUNITY PARTICIPATION IN THE DEVELOPMENT OF ECOTOURISM IN THE LOWER KINABATANGAN AREA OF SABAH: THE CHALLENGES
		10.2	Chair : Dr. Balvindar Kaur Kler, Universiti Malaysia Sabah			
			A	1517	HUANG, Molly Chien-jung	Selling a place: brand effect to destination – the case of Sun Moon Lake, Taiwan
			B	1504	HUANG, Yun-Chieh	Management Effectiveness Evaluation as a way to promote interactions between protected areas and communities – A case study of Tawushan Natural Reserve in Taiwan
			C	1427	Chieh-Lu Li	Customer Services in Parks and Recreation: A Taiwan Ethnic Study
			D	1362	KITTICHAROENKUN, Chanoknun T	Sustainable Forests and Water Policy in Thailand-- A Meta-Analysis
		10.3	Chair : Dr. Neelam C. Poudyal, University of Georgia, USA			
			A	1415	Michelle Smith	Agrarian and social change: A community desire for social change and resource protection in Lao PDR
			B	1580	Clotilde Luquiau	Concept of Nature among the different stakeholders of a conservation area: from perception to competition between development strategies in the lower Kinabatangan in Sabah.
			C	1529	Ai-Tsen Su	Estimating the Cultural, Creative and Conservation Values of Kinmen National Park, Taiwan
		10.4	Chair : Dr. Neelam C. Poudyal, University of Georgia, USA			
			A	1585	Chih-Liang Chao	Management of Dadu Estuary Wildlife Refuge in Taiwan: Challenges and Rethinking from Landscape Change
			B	1440	Jui-Ying Hung	The Study of Tourists' Personality how to Influence Future Tourism Behavior Intention in Perceived Risk of Destination - the Case of Climate Change and Political Violence
			C	1452	Peter Fredman	Commodification of Nature through Wildlife – Observations of Supply and Demand of Wildlife Tourism in Sweden
		10.5	Chair: Dr. Balvindar Kaur Kler, Universiti Malaysia Sabah			
			A	1420	Wen-Bor Lu	Exploring the Value Connotation of Rural Tourism in Siraya National Scenic Area of Taiwan
			B	1400	Susan Rockloff	Commodification of nature: selling authenticity in ecotourism activities
			C	1468	ALITA ROXAS	Commodification of Forest Resources and Food Security in the Mt. Malindang Range Natural Park, an Upland Protected Area in the Philippines
		10.6	Chair : Dr. Balvindar Kaur Kler, Universiti Malaysia Sabah			
			A	1471	Neelam Poudyal	Impact of Visibility Impairment on National Park Visitation
			B	1434	Hsien-Chieh Chou	Comparing the Importance of Critical Factors When Deciding Recreational Carrying Capacity between Forest Recreation Areas and National Parks in Taiwan
			C	1624	HUONG, Do	Differences between Western and Vietnamese ecotourists - Evidence from Cat Tien National Park, Vietnam
			D	1512	Mei-Fen Lee	The affects of vegetation in campus on attention of elementary school students

SECTION B: ORGANISED SESSION

SESSION NO	CATEGORY	Organised Session: Organised Session: Cultures of oil palm: smallholder livelihoods, network and knowledge Organiser : George Curry (Curtin University), Fadzilah Majid Cooke (Universiti Malaysia Sabah)				
		Session Sub-No	Paper No	ID No	Author	Title
11	Cultures of Oil Palm	11.1	Chair : Prof. Lesley Potter, ANU			
			A	1395	Tania Murray Li	Indonesia's Oil Palm Labour Regime
			B	1582	Colin Filer	The Expansion of the Virtual Oil Palm Industry in Papua New Guinea
			C	1596	Fadzilah Majid Cooke	In the name of poverty alleviation: experiments with oil palm small holders and customary lands in Sabah
			D	1442	Rob Cramb	The Growth of Smallholder Oil Palm in Sarawak, Malaysia
		11.2	Chair :			
			A	1446	Oliver Pye	Precarious lives: transnational biographies of migrant palm oil workers
			B	1462	Lesley Potter	Plantations, smallholders, elites and traditional growers: the dynamics of oil palm production in Cameroon
			C	1584	John F McCarthy	Understanding the Oil Palm Complex in Indonesia and Malaysia
		11.3	Chair :			
			A	1567	Sunny Sanderson	Malaysian oil palm & Indonesian labour migration
			B	1460	G Koczberski/V Bue	Food Security among Oil Palm Smallholders in West New Britain Province, Papua New Guinea
			C	1449	George N. Curry	Smallholder Productivity and the Social Embeddedness of Oil Palm Production in Papua New Guinea
			D	1480	Matthew Allen	Smallholder engagement with a commercial oil palm operation on Guadalcanal, Solomon Islands

SESSION NO	CATEGORY	Organised Session: Nurturing new geographies of coexistence Organiser : Richard Howitt (Macquarie University), Gaim James Lunkapis (Universiti Malaysia Sabah)				
		Session Sub-No	Paper No	ID No	Author	Title
12	Cultural interfaces in NRM	12.1	Chair : Dr. L. C. Sevidal Castro, Mindanao University-Iligan Institute of Technology			
			A	1483	Richie Howitt	Rethinking Capacity Deficits at Cultural Interface: a provocation for natural resource management systems
			B	1647	Jillian Marsh	Native Title and Commercial Mining Relations in Australia: Indigenous Cultural Heritage Places and the Integrity of Creation
			C	1571	Stephen Wyatt	Indigenous people and management of Canada's forest sector: creating space for negotiating collaboration and coexistence
			D	1574	Paul Porodong	Indigenous Knowledge on Soil Potential
		12.2	Chair :			
			A	1573	Sandie Suchet-Pearson	Situating engagements in natural resource management with non-human worlds
			B	1518	Sherrie Cross	Contemporary Indigenous governances: a conceptual framework for negotiating resource development and conservation in Indigenous lands
			C	1366	Justine Vaz	Revisoning conservation: finding spaces for people in Sabah's protected area network
			D	1575	Pascal Scherre	"It's not about believing" – exploring the transformative potential of cultural tolerance in tourism
		E	1323	Gaim Lunkapis	Ethnoecological Knowledge of Indigenous Communities Living at the Periphery of the Imbak Canyon Conservation Area, Sabah, Malaysia	

SESSION NO	CATEGORY	Organised Session: The role of politics, economics and sciences in climate change adaptation behaviour. Organiser : Zoe Leviston (CSRIO, Australia)				
		Session Sub-No	Paper No	ID No	Author	Title
13	Climate Change	13.1	Chair : Dr. Evonne Miller, Queensland University of Technology			
			A	1376	Zoe Leviston.	Climate change and the Australian community: Image Associations, emotional responses and behaviours
			B	1405	Murni Greenhill	Creating Local Storylines for Climate Futures: A new approach for communicating climate change in Perth, Western Australia
			C	1384	Sorada Tapsuwan	Adapting to less water: a choice experiment study of preferences for water harvesting technology at the household level
			D	1404	Melissa Green	Identifying and overcoming climate change risks within Australia's Forestry Industry: A social science perspective on pathways to adoption

SESSION NO	CATEGORY	Organised Session: Water, Lifestyle and Urban Sustainability in Malaysia				
		Session Sub-No	Paper No	ID No	Author	Title
14	Water, Lifestyle and Urban Sustainability	Organiser : Shuhana Shamsuddin (Universiti Teknologi Malaysia)				
		14.1	Chair :			
			A	1554	Shuhana Shamsuddin **	Human actions and the sustainability of the waterfront areas in Malaysian cities
			B	1550	Ibrahim Ngah **	Low carbon lifestyle and urban sustainability
			C	1556	Choong Weng Wai **	The Process of Fostering Sustainable Awareness and Behaviour among Urban Communities
D	1438	Zuraini Anang	Assessing the Effective Demand for Improved Water Supply Services in Malaysia: Focusing on Johor Water Supply			

SESSION NO	CATEGORY	Organised Session: Transacting property rights in forest carbon				
		Session Sub-No	Paper No	ID No	Author	Title
15	Property Rights	Organiser : Colin Filer, Sango Mohanty (Australian National University)				
		15.1	Chair :			
			A	1590	Pham Thu Thuy	REDD+ politics in the media: a case study from Vietnam
			B	1598	Do Hoan	A landscape REDD+ approach in Bac Kan province of Vietnam: drivers, threats and responses
			C	1591	Zulkifli Lubis	Reinventing local wisdom for sustainable peatland and forest management through REDD+: some opportunities and challenges for KFCP's REDD project in Central Kalimantan
		D				
		15.2	Chair :			
			A	1593	Andrea Babon	Our carbon, their forest: equity implications of reducing emissions from deforestation and forest degradation (REDD) in Papua New Guinea
			B	1594	Michael Wood (Colin Filer)	Property transformations and developing carbon markets in Papua New Guinea
			C	1592	Sarah Milne	Property relations in the context of contracts for avoided deforestation in Cambodia
D						

SESSION NO	CATEGORY	Organised Session: A Unifying Framework for Understanding and Evaluating Natural Resource Negotiation and Decision Situations: Applications to Agriculture, Climate Change, Forest Practices, and Water Basin Management Organiser : Greg Walker (Oregon State University)				
		Session Sub-No	Paper No	ID No	Author	Title
16	NRM and Decision Making	16.1	Chair :			
			A	1344	Gregg Walker	Resilience, Creativity, and Constraints in Climate Negotiations: Insights from the Unifying Framework
			B	1626	Jens Emborg	The Unifying Negotiation Framework (UNF) – background, purpose and overview
			C	1617	Maya Sepehri	Social Dimensions of REDD+: Adapting a Unifying Negotiation Framework to Assess Conflicts Related to a Cambodian REDD+ Project
		16.2	Chair :			
			A	1631	Cathy Brown (Jens Emborg)	Taking the UNF to Public Natural Resource Management Professionals: A Sense-making Tool for Citizen Involvement in Public Forest and Nature Planning
			B	1629	Jennifer Bond (Maya Sepehri)	The Unifying Negotiation Framework as a context analysis tool for designing agricultural interventions
C	1630	Deidra Spencer (Gregg Walker)	Confronting Complexity and Controversy surrounding Dam Removal in the Klamath Basin: A Unifying Framework Analysis			

SESSION NO	CATEGORY	Organised Session: The impacts of the imperfect storm on Northeast Japan Organiser : A.E. Luloff (Pennsylvania State University), Shinichi Kurihara (Chiba University) Note : non-paper discussion session				
		Session Sub-No	Paper No	ID No	Author	Title
17	Natural Disaster	17.1	Chair : A. E. Luloff, Penn. University			
			A	1564	A. E. Luloff	The Impacts of the Imperfect Storm on Northeast Japan [SEC. Note: Introduction to Panel]
			B	1637	Atsushi Maruyama	How Did the Big Earthquake and Tsunami affect Japan: An overview
			C	1634	Seiichi Sakurai	Impacts of Earthquake, Tsunami and Nuclear Issue on the Food Distribution System in East Japan
			D	1635	Miima Nishiyama	Community Reconstruction Initiatives Following the Earthquake. Tsunami and Nuclear disaster
			E	1633	Shimpei Shimoura	Organization and Networking of Citizens' Volunteer Work: Case Study on Earthquake Relief Activities in Japan
			F	1632	Shinichi Kurihara	Analysis of Consumer's Behavior in the Metropolitan Area after the Tohoku Earthquake

SESSION NO	CATEGORY	Session Sub-No	Roundtable and Panel on Indigenous and Community Conserved Areas: Challenges, Opportunities, and Next Steps		
18	Property Rights	18.1 and 18.2	Part I Roundtable Participants: 90 Minutes		
			Facilitator: Jannie Lasimbang (Malaysia Human Rights Commission)		
			1. Datuk Sam Mannan (Sabah Forestry Department)		
			2. Cynthia Ong (LEAP)		
					3. Anne Lasimbang (PACOS)
					4. Rosli Jukrana (MESCOT)
					Part II Panel Speakers: 90 Minutes
					Chair: Holly Shrumm (Natural Justice)
					1. Sweta Mishra (Concern World Wide, India) – “The Forest Rights Act: A Changing Conservation Paradigm”
					2. Holly Shrumm (Natural Justice) – “International Advancements in Recognizing and Supporting Community Conservation and Associated Rights”
			3. Justine Vaz (Global Diversity Foundation) – “Embracing Community Conserved Areas in Sabah”		

LIST OF PARTICIPANT SORTED BY LAST NAME

NO	SESSION NO/POSTER	ID	LAST NAME	FIRST NAME	AFFILIATION	EMAIL
1.	2.3	1455	Abdul Halim	Norhazimah	Universiti Malaysia Pahang	aimc_86@yahoo.com
2.	5.1	1509	Abdul Rahman	Umi A' Zuhrah	WWF-Malaysia	urahman@wwf.org.my
3.	5.1	1484	AKAMINE	JUN	Nagoya City University	akamine@hum.nagoya-cu.ac.jp
4.		1657	Ali	Saleem	University of Vermont	saleem.ali@uvm.edu
5.	11.3	1480	Allen	Matthew	The Australian National University	matthew.allen@anu.edu.au
6.	14.1	1438	Anang	Zuraini	University Malaysia Terengganu	zura@umt.edu.my
7.	1.1	1597	Ariffin	Jamilah	Koperasi Pembangunan Desa	jlInchoon@hotmail.com
8.	1.5	1669	Arizpe	Nancy	Institut de Ciència i Tecnologia Ambientals, UAB	nancy.arizpe@gmail.com
9.	15.2	1593	Babon	Andrea	Charles Darwin University	andrea_babon@yahoo.com
10.	7.1	1336	Baldwin	Claudia	University of the Sunshine Coast	cbaldwin@usc.edu.au
11.	7.2	1643	Begum	Khaleda	Bangladesh University of Engineering and Tec.	khaleda58@gmail.com
12.	8.1	1486	Bose	Indranil	The University of Hong Kong	bose@business.hku.hk
13.	1.3	1447	Brown	Trent	University of Wollongong	trentpbrown@gmail.com
14.	4.1	1461	Budruk	Megha	Arizona State University	Megha.Budruk@asu.edu
15.	11.3	1460	Bue	Veronica	Curtin University	vgawibue@gmail.com
16.		1673	Buensalida	Fernand	MINRICE	fbuensalida04@yahoo.com
17.	10.4	1585	Chao	Chih-Liang		clchao@pu.edu.tw
18.	2.1	1419	Chellan	Noel	University of KwaZulu-Natal	chellan@ukzn.ac.za
19.	9.1	1496	Chen	Ying Chun	National Taiwan University	r99628306@ntu.edu.tw
20.		1497	Chen	Ying-Tzu	National Taiwan University	r98625013@ntu.edu.tw
21.	7.1	1516	Chen	Wei-Lin	Providence University	g9535007@gmail.com
22.		1667	Chen	Mei-Hui	Forestry Bureau	s0990055@mail.ncyu.edu.tw
23.	1.1	1654	Chong	KhimPhin	Univerersiti Malaysia Sabah	chongkp@ums.edu.my
24.	10.6	1434	Chou	Hsien-Chieh	National Chung Hsing University	s8828046@hotmail.com
25.		1678	Chuah	Tse-Seng	Universiti Malaysia Terengganu	chuahts@umt.edu.my
26.		1377	Corpuz	Rosalie	Symbiosis Consulting	rccorpuz@aol.com
27.	11.1	1442	Cramb	Rob	University of Queensland	r.cramb@uq.edu.au
28.	12.2	1518	Cross	Sherrie	Department of Geography, Macquarie University	sherrie.cross@optusnet.com.au
29.	11.3	1449	Curry	George	Curtin University	g.curry@curtin.edu.au

30.	16.1	1626	Emborg	Jens	University of Copenhagen	jee@life.ku.dk
31.	11.1	1582	Filer	Colin	Australian National University	colin.filer@anu.edu.au
32.	7.4	1595	Foo	Jurry	Universiti Malaysia Sabah	jurryfoo@gmail.com
33.	3.1	1485	Foo	Siang Choon	WWF-Malaysia	rfoo@wwf.org.my
34.	10.4	1452	Fredman	Peter	Mid-Sweden University	peter.fredman@miun.se
35.	6.1	1456	Ganguly-Scrase	Ruchira	University of Wollongong, Australia	rgscrase@uow.edu.au
36.	10.1	1566	Ghasemi	Moslem	Center for Innovative Planning & Development	m.ghasemi955@gmail.com
37.	10.1	1542	Gokita	Reiko	Japan Travel Bureau Foundation	gokita@jtb.or.jp
38.	1.2	1380	Goldstein	Jenny	University of California, Los Angeles	jgoldstein@ucla.edu
39.	9.1	1351	GOMEZ	AURELIA LUZVIMINDA	CHARLES DARWIN UNIVERSITY, AUSTRALIA	aurelia.gomez@cdu.edu.au
40.	13.1	1404	Green	Melissa	CSIRO	melissa.green@csiro.au
41.	13.1	1405	Greenhill	Murni	CSIRO	murni.greenhill@csiro.au
42.	2.1	1333	Haque	Md. Ubydul	Nagasaki University	uhicddrb@yahoo.com
43.	15.1	1598	Hoan	Do	World Agroforestry Centre	hoanicraf@gmail.com
44.	2.2/9.1	1503	Hou	Jing-Shoung	Tung-Hai University, Taiwan	hou08@thu.edu.tw
45.	12.1	1483	Howitt	Richard	Macquarie University	richie.howitt@mq.edu.au
46.	10.1	1383	Hsu	Yi-Chung	National Dong Hwa University	yhsu@mail.ndhu.edu.tw
47.	9.1	1473	Hsu	Pei-Hsin	Providence University	peihsin.hsu@gmail.com
48.		1587	Hsu	Chung-Kai	Lienhuachih Research Center, TFRI, COA,	dakai0327@gmail.com
49.		1398	Hu	Weihsing	National Taipei University of Technology	ymchang@ntut.edu.tw
50.		1454	Huang	Tsui-fen	Ph.D.Program in Design,Chung Yuan Christian Univ.	tkslsd5052@yahoo.com.tw
51.	10.2	1504	Huang	Yun-Chieh	National Taiwan University	R98625023@ntu.edu.tw
52.	10.2	1517	Huang	Molly Chien-jung	Aletheia University on Matou Campus	au2535@mail.au.edu.tw
53.	7.2	1378	Humphries	Shoana	Forest Stewardship Council International Center	shoana_h@hotmail.com
54.	10.4	1440	Hung	Jui-Ying	Chao-Yang University of Technology	jybong@cyut.edu.tw
55.	10.2	1624	Huong	Do	Griffith University	h.do@griffith.edu.au
56.	10.1	1325	Hussein	Rosazman	Universiti Malaysia Sabah	drazzros@gmail.com
57.	1.5	1620	Hwang	Yuan-Cherng	Science and Technology Institute of N. Taiwan	pauylchwang@aim.com
58.	1.2	1579	Jakimow	Tanya	Commonwealth Science and Industrial Research Org	Tanya.Jakimow@csiro.au
59.	1.2	1332	Jones	Robert	University of Tennessee	mountain@utk.edu
60.	18	D	Jukrana	Rosli		
61.	8.1	1330	Kamran	Muhammad	Asian Institute of Technology Thailand	agriecon.niab@gmail.com
62.		1558	KANTI	ATIT	BOGOR AGRICULTURE UNIVERSITY	sudianai@yahoo.com

63.		1538	Kao	Hao-Ling	National Chiayi University	yoshiki520520@yahoo.com.tw
64.	10.2	1362	Kitticharoenkun	Chanoknun	Faculty of Economics, Thammasat University	snoopy_tle92@hotmail.com
65.	7.2	1521	KLER	BALVINDER	UNIVERSITI MALAYSIA SABAH	balvinder@ums.edu.my
66.	11.3	1439	koczberski	gina	curtin university	g.koczberski@curtin.edu.au
67.		1619	Kumagai	Yoshitaka	Akita International University	ykumagai@aiu.ac.jp
68.	17.1	1632	Kurihara	Shinichi		kuri@faculty.chiba-u.jp
69.	3.1	1541	Kurniawati	Catur Arik		ariex_97@yahoo.com
70.	7.1	1448	Lai	Jung-Yi	Laboratory For Environment & Form	lai.roy@msa.hinet.net
71.	2.1	1422	Landauer	Mia	BOKU university Vienna, Austria	mia.landauer@boku.ac.at
72.	18	D	Lasimbang	Anne	PACOS	lasimbang@gmail.com
73.	18	D	Lasimbang	Jannie	SUHAKAM	jannielasimbang@gmail.com
74.	2.2	1467	Lee	Su-Hsin	National Taiwan Normal University	shlee@ntnu.edu.tw
75.	10.6	1512	Lee	Mei-Fen	National Chin-Yi University of Technology	mei_fen_lee@yahoo.com.tw
76.		1621	Lee	Dong-ho	Seoul National Univeristy, The Repulic of Korea.	ochrysalis@gmail.com
77.	13.1	1376	Leviston	Zoe	CSIRO	zoe.leviston@csiro.au
78.	7.4	1350	Li	Ying-Hung	Feng Chia University	yhli@fcu.edu.tw
79.	11.1	1395	Li	Tania	University of Toronto	tania.li@utoronto.ca
80.	10.6	1427	Li	Chieh-Lu	National Chung Hsing University	CXL345@gmail.com
81.	9.2 (P)	1493	Liao	Wan-Ting	National Taiwan University	wantin1122@hotmail.com
82.		1570	Liao	Chin-Wen	National Changhua University of Education	tcwliao@cc.ncue.edu.tw
83.		1466	Lin	Chia-Nan	Dept. of Geography, National Taiwan University	d97228002@ntu.edu.tw
84.	9.2 (P)	1464	Liu	Shih-Yung	China University of Technology	deshouse@ms46.hinet.net
85.	9.2 (P)	1465	Liu	Yi-Ching	Tungnan University/Chung Yuan Christian University	liu0129@mail.tnu.edu.tw
86.	9.2 (P)	1506	Liu	Yi-Ching	Tungnan University/Chung Yuan Christian University	liu0129@ms26.hinet.net
87.	3.1	1402	Lu	Bing-Yan	National Dong Hwa University	bylu@mail.ndhu.edu.tw
88.	10.5	1420	Lu	Wen-Bor	National Chung Hsing University	fisher27@hotmail.com
89.	3.1	1510	Lu	Dau-Jye	National Taiwan University	djlu@ntu.edu.tw
90.	15.1	1591	Lubis	Zulkifli	University of North Sumatra	flibis08@gmail.com
91.	7.3	1666	Lukasiewicz	Anna	Charles Sturt University	alukasiewicz@csu.edu.au
92.	17.1	1564	Luloff	A. L.	penn state	aeluloff@psu.edu
93.	12.2	D1323	Lunkapis	Gaim James	Universiti Malaysia Sabah	gaim.ums@gmail.com
94.	10.3	1580	Luquiau	Clotilde	Paris Ouest/ Paris I Sorbonne	clotilde.luquiau@ymail.com
95.	11.1	1596	Majid Cooke	Fadzilah	Universiti Malaysia Sabah	fadzilahc@hotmail.com

96.	7.3	1410	Mankad	Aditi	CSIRO	aditi.mankad@csiro.au
97.	18	D	Mannan	Sam	Department of Forestry, Sabah	htan@sabah.gov.my
98.	12.1	1647	Marsh	Jillian	Batchelor Institute of Indigenous Tertiary Education	jillian.marsh@batchelor.edu.au
99.		1366	Martin	Gary	GDF	GMartinGDF@gmail.com
100.	17.1	1637	Maruyama	Atsushi	CHIBA University	a.maruyama@faculty.chiba-u.jp
101.	8.1	1426	Masae	Awae	National Institute of Development Administration	awae.m@nida.ac.th
102.	6.1	939	Mau	Paulus	BC Hydro	cmau@sfu.ca
103.	8.1	1331	McCann	Gregory	Chang Gung University	greg.mccann1@gmail.com
104.	11.2	1584	McCarthy	John	Australian National University	john.mccarthy@anu.edu.au
105.	4.1	1412	Meguro	Toshio	The University of Tokyo	meguroguro@gmail.com
106.	1.3	1494	Millar	Joanne	Charles Sturt University	jmillar@csu.edu.au
107.	2.2	1381	Miller	Evonne	Queensland University of Technology	e.miller@qut.edu.au
108.	15.2	1592	Milne	Sarah	Australian National University	sarah.milne@anu.edu.au
109.	18	1437	Mishra	Sweta	Concern World Wide, India	swetamishra1@gmail.com
110.	8.2	1347	Miyauchi	Taisuke	Hokkaido University	miyauchi@let.hokudai.ac.jp
111.	1.5	1401	Mostegl	Nina	Simon Fraser University	nina.mostegl@gmail.com
112.	1.2	1432	Namgay	Kuenga	Charles Sturt University	knamgay@csu.edu.au
113.	17.1	1635	NISHIYAMA	MIMA	Chiba University	mima@faculty.chiba-u.jp
114.	2.1	1526	Nordensvard	Johan	London School of Economics and Politics	J.O.Nordensvard@lse.ac.uk
115.	18	D	Ong	Cynthia	LEAP	cynthia@leapspiral.org
116.		1645	OTHMAN	SYAHANEEM	WWF-MALAYSIA	sothman@wwf.org.my
117.		1352	PALISADA	MA. ELENA	ATENEO DE DAVAO UNIVERSITY, PHILIPPINES	maep8wals9502@yahoo.com
118.	7.1	1490	Peng	An-chi	National Taiwan University	onezephyrangel@hotmail.com
119.	8.2	1374	Peters	Robert	Monash University	rfpet1@student.monash.edu
120.	11.2	1462	Potter	Lesley	Australian National University	lesley.potter@anu.edu.au
121.	12.1	1574	Porodong	Paul	Universiti Malaysia Sabah	pporodong@yahoo.co.uk
122.	10.6	1471	Poudyal	Neelam C.	University of Georgia	npoudyal@warnell.uga.edu
123.	11.2	1446	Pye	Oliver	Bonn University	oliver.pye@uni-bonn.de
124.		1612	Reyes	Camila		C.Reyes@massey.ac.nz
125.	10.5	1400	Rockloff	Susan	CQUniversity Australia	s.rockloff@cqu.edu.au
126.	10.5	1468	ROXAS	ALITA	MINDANAO STATE UNIV-ILIGAN INSTITUTE OF TEC.	alitaroxas@gmail.com
127.	17.1	1634	Sakurai	Seiichi	Chiba University	sakurai@faculty.chiba-u.jp
128.	11.3	1567	Sanderson	Sunny	The University of Queensland	s.sanderson@uq.edu.au

129.	7.4	1399	Sasaoka	Masatoshi	Center for International Forestry Research (CIFOR)	m.sasaoka@cgiar.org
130.	12.2	1575	Scherrer	Pascal	Southern Cross University	pascal.scherrer@scu.edu.au
131.	1.3	1475	Scrase	Tim	Australian Catholic University	tim.scrase@acu.edu.au
132.	16.1	1617	Sepehri	Maya	University of Copenhagen	mase@life.ku.dk
133.	17.1	1633	Shimoura	Shinpei	Chiba University, Japan	shimoura@faculty.chiba-u.jp
134.	18	D	Shrumm	Holly	Natural Justice	holly@naturaljustice.org
135.	1.3	1390	Shtaltovna	Anastasiya	Center for Dev. Research, Uni Bonn, Germany	ashtaltovna@yahoo.com
136.	1.4	1470	Siry	Jacek	University of Georgia	jsiry@warnell.uga.edu
137.	10.3	1415	Smith	Michelle	Charles Sturt University	michellesmith_81@hotmail.com
138.	10.3	1529	Su	Ai-Tsen	National Taiwan University	f95628302@ntu.edu.tw
139.	12.2	1573	Suchet-Pearson	Sandie	Macquarie University	sandie.suchet@mq.edu.au
140.	4.1	1498	Sugimoto	Ayumi	University of Tokyo	sugimoo@hotmail.com
141.	13.1	1384	Tapsuwan	sorada	CSIRO	sorada.tapsuwan@csiro.au
142.		1608	Teng	Jeraldine	Massey University	j.teng@massey.ac.nz
143.		1672	Thou	TSEN	Freelance Consultancy	pgtsen@tm.net.my
144.	15.1	1590	Thuy	Pham	Charles Darwin University	brissiesugar@gmail.com
145.	1.1	1474	Thulstrup	Andreas Waaben	Roskilde University	waaben@ruc.dk
146.	1.4	1530	Tsuchiya	Toshiyuki	Tokyo University of Agriculture and Technology	toshit@cc.tuat.ac.jp
147.		1349	TUKIMAT	NURUL N. AQILAH	UNIVERSITI TEKNOLOGI MALAYSIA	nashaq85@yahoo.com
148.	6.1	1536	Urban	Frauke	Institute of Development Studies IDS	f.urban@ids.ac.uk
149.	12/18	D1614	Vaz	Justine	Global Diversity Foundation	justine.vaz@gmail.com
150.	16.1	1344	Walker	Gregg	Oregon State University	gwalker@oregonstate.edu
151.	8.2	1487	Wang	Hsin-Han	Department of Tourism, Providence University	shnhanwang@gmail.com
152.	1.4	1532	Wang	Hurng-Jyuhn	National Chiayi University	hongjinwang@gmail.com
153.	5.1	1576	Weber	Delene	University of South Australia	delene.weber@unisa.edu.au
154.	1.5	1481	Williams	Liana	CSIRO	liana.williams@csiro.au
155.		1549	Wilmot	Fiona	Texas A&M University	fionawilmot@neo.tamu.edu
156.	7.2	1379	Wong	Terrie	Arizona State University	terrie.wong@asu.edu
157.	12.1	1571	Wyatt	Stephen	Université de Moncton	swyatt@umce.ca
158.	10.3	1329	Yang	Ming-Ching	National Chi-Nan University	mctony@ncnu.edu.tw

D = Daily Ticket/Pass